

CYLINDRICAL ROLLER BEARING

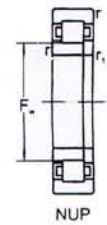
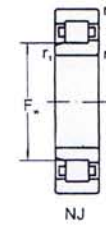
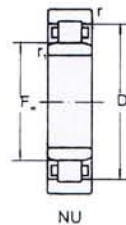
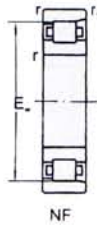
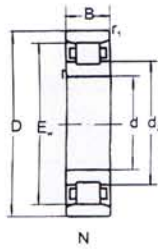

d	D	B	Fw	Ew	Bearing No.	kg
17	40	16	22.1		NUP2203ETN1	0.097
20	47	14		41.5	N204E	0.114
	47	14		41.5	NF204E	
	47	14	26.5		NU204E	
	47	14	26.5		NJ204E	
	47	14	26.5		NUP204E	
	47	18		41.5	N2204E	0.145
	47	18		41.5	NF2204E	
	47	18	26.5		NU2204	
	47	18	26.5		NJ2204E	
	47	18	26.5		NUP2204E	
	52	15		45.5	N304E	0.152
	52	15		45.5	NF304	
	52	15	27.5		NU304E	
	52	15	27.5		NJ304E	
	52	15	27.5		NUP304E	
	52	21		45.5	N2304E	0.212
	52	21		45.5	NF2304E	
	52	21	27.5		NU2304E	
	52	21	27.5		NJ2304E	
	52	21	27.5		NUP2304E	
25	52	15		46.5	N205ETN1	0.136
	52	15		46.5	NF205ETN1	
	52	15	31.5		NU205ETN1	
	52	15	31.5		NJ205ETN1	
	52	15	31.5		NUP205ETN1	
	52	15	31.5		NJ205	0.137
	52	18		46.5	N2205E	0.163
	52	18		46.5	NF2205E	
	52	18	31.5		NU2205E	
	52	18	31.5		NJ2205E	
	52	18	31.5		NUP2205E	
	62	17		54	N305ETN1	0.246
	62	17		54	NF305ETN1	
	62	17	34		NU305ETN1	
	62	17	34		NJ305ETN1	
	62	17	34		NUP305ETN1	
	62	17		53	N305	0.24

d	D	B	Fw	Ew	Bearing No.	kg
25	62	17		53	NF305	
	62	24		54	N2305E	0.347
	62	24		54	NF2305E	
	62	24	34		NU2305E	
	62	24	34		NJ2305E	
	62	24	34		NUP2305E	
	30	62	16		55.5	N206ETN1
62		16		55.5	NF206ETN1	
62		16	37.5		NU206ETN1	
62		16	37.5		NJ206ETN1	
62		16	37.5		NUP206ETN1	
62		16		53.5	N206	0.219
62		16	38.5		NU206	
62		16	38.5		NJ206	
62		16	38.5		NUP206	
62		20		55.5	N2206E	.0262
62		20		55.5	NF2206E	
62		20	37.5		NU2206E	
62		20	37.5		NJ2206E	
62		20	37.5		NUP2206E	
72		19		62.5	N306E	0.368
72		19		62.5	NF306E	
72		19	40.5		NU306E	
72		19	40.5		NJ306E	
72	19	40.5		NUP306E		
72	19		62	N306	0.355	
72	19	42		NU306		
72	19	42		NJ306		
72	27		62.5	N2306E	0.526	
72	27		62.5	NF2306E		
72	27	40.5		NU2306E		
72	27	40.5		NJ2306E		
72	27	40.5		NUP2306E		
35	72	17		64	N207ETN1	0.305
	72	17		64	NF207ETN1	
	72	17	44		NU207ETN1	
	72	17	44		NJ207ETN1	
	72	17	44		NUP207ETN1	